



## RP08X type pressure reducing valves - 3 way

- Solenoid proportional type, pilot operated
- With relieving (NO)
- Spool type

Technical specifications and diagrams are measured with mineral oil of 46 cSt viscosity at 40°C (104°F) temperature.

RP08X		
Nominal flow		15 l/min (4 US gpm)
Max. pressure		350 bar (5100 psi)
Oil leakage		-
Fluid		mineral based oil
Viscosity		10-200 cSt
Max level of contamination		18/16/13 ISO4406
Fluid temperature	with NBR seals	from -20°C (-4°F) to 80°C (176°F)
	with FPM seals	from -20°C (-4°F) to 100°C (212°F)
Environmental temp. for working conditions		from -20°C (-4°F) to 50°C (122°F)
Cavity		SAE 08/3
Coil type*		BDP19
Nominal voltages		12 VDC - 24 VDC
Power rating		13 W (12 VDC) - 13.25 W (24 VDC)
Max control current		12 V -> 1.9 A - 24 V -> 0.9 A
Dither frequency		150 Hz
Hysteresis		≤4%
Weight		0.56 kg (1.23 lb)

NOTE - For different conditions, please contact Walvoil Sales Dpt. - For coils further features see from page 206.

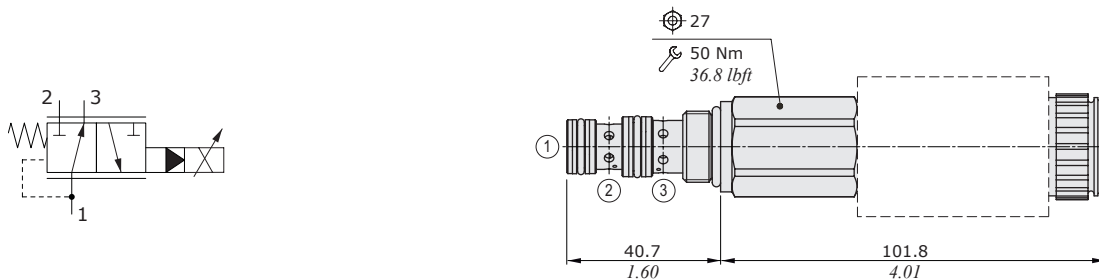

## Ordering codes and description composition

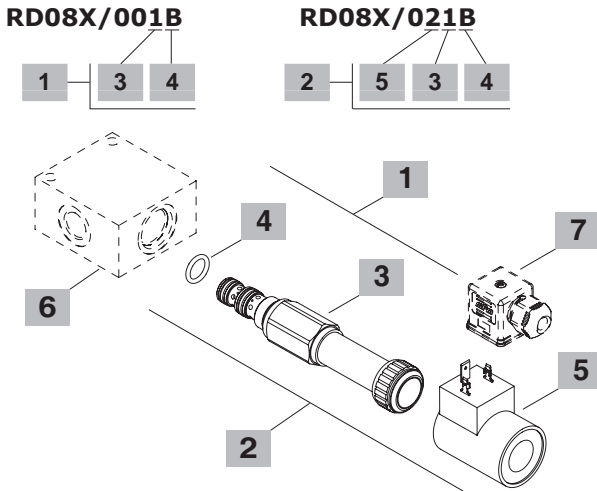

### 1 Cartridges

TYPE	CODE	DESCRIPTION
<b>RP08X/001B</b>	ORP08002010	Pressure range <b>1</b>
<b>RP08X/002B</b>	ORP08002011	Pressure range <b>2</b>
<b>RP08X/003B</b>	ORP08002012	Pressure range <b>3</b>
<b>RP08X/004B</b>	ORP08002013	Pressure range <b>4</b>

### 2 Complete cartridges

TYPE	CODE	DESCRIPTION
<b>RP08X/021B</b>	ORP08002007	Pressure range <b>1</b> , 12VDC
<b>RP08X/022B</b>	ORP08002001	Pressure range <b>2</b> , 12VDC
<b>RP08X/023B</b>	ORP08002002	Pressure range <b>3</b> , 12VDC
<b>RP08X/024B</b>	ORP08002003	Pressure range <b>4</b> , 12VDC

### 3 Pressure range

TYPE	DESCRIPTION
<b>1</b>	Pressure range 10÷50 bar (145÷725 psi)
<b>2</b>	Pressure range 50÷200 bar (725÷2900 psi)
<b>3</b>	Pressure range 80÷350 bar (1160÷5075 psi)
<b>4</b>	Pressure range 20÷100 bar (290÷1450 psi)

### 4 Seals

TYPE	DESCRIPTION
<b>B</b>	<b>NBR (Buna)</b> o-ring seals, std configuration
<b>V</b>	<b>FPM (Viton)</b> o-ring seals, contact Sales Dept.

### 5 Coils

TYPE	CODE	DESCRIPTION
<b>2) BDP19 12VDC</b>	4SL5000120	12VDC-ISO4400 coil
<b>4) BDP19 24VDC</b>	4SL5000240	24VDC-ISO4400 coil

For complete coils list see page 206

### 6 Valve body

TYPE	CODE	DESCRIPTION
<b>SAE 08/3-G 3/8</b>	3CC0830C11	Aluminium body for cavity 10 valve, G 3/8 std thread

Note: aluminium body can stand up to 210 bar (3050 psi)  
For steel bodies or different threading see from page 217

### 7 Connector

TYPE	CODE	DESCRIPTION
<b>ISO4400</b>	4CN1009995	Connector

For complete connectors list see from page 206

## Rating diagram

**Pressure drop vs. flow 2->1**  
with de-energized coil

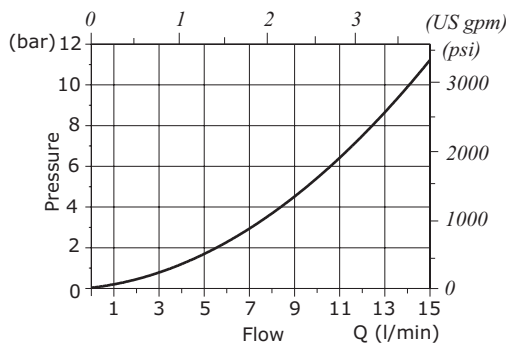

**Pressure drop vs. flow 1->3**

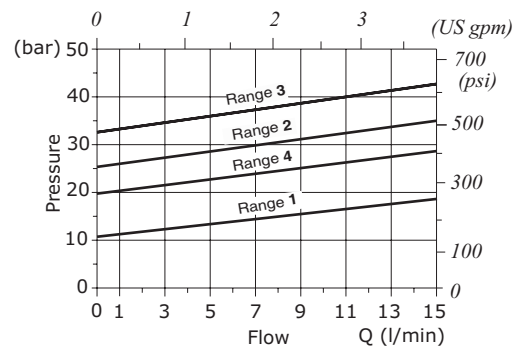

**Pressure reducing vs. control current**

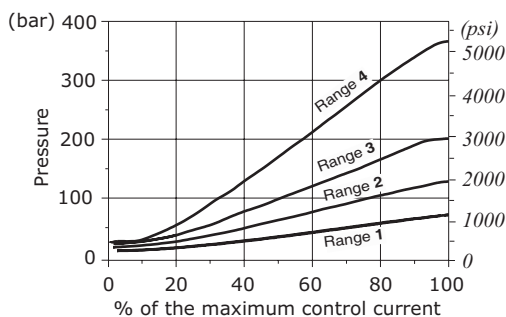

**Reducing/relieving pressure vs. flow**  
for % of control current - Pressure range 2

